

1P - 1T

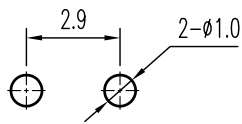

示意图 SCHEMATIC



安装孔 PIERCING PLAN

规格 Specifications

额定负荷 Ratings	DC 16 V 0.1 A
接触阻抗 Contact Resistance	40 mΩ Max.
绝缘阻抗 Insulation Resistance	DC 250 V 60±5 Sec. 100 MΩ Min.
抗电强度 Dielectric	AC 250 V (50~60HZ) 60±5 Sec.
操作力 Operating Force	40±20 gf
机械寿命 Operating Life Without Load	200,000 次 Cycles

5	接触头 CONTACT RIVET	SILVER	2	NATURAL				
4	端子 TERMINAL	C1720R	2	NATURAL				
3	杠杆 LEVER	P O M	1	BLACK				
2	胶壳 HOUSING	P B T	1	BLACK	①	ADD: 1.1	Sun j c	7-5-05
1	胶盖 COVER	P B T	1	BLACK	标号 REV	内容 DESCRIPTION	签名 SIGN.	日期 DATE
序NO.	零件 PART	材料 MATERIAL	数量 QTY	备注 REMARKS	DWG NO. ITEM2388			

TOLERANCES UNLESS OTHERWISE SPEC.		TITLE	DETECTOR SWITCH		ITEM NO	DS-050		
UNDER 1	± 0.10	DRAWN	J.H.HE	7-5-05	VERSION	A01	PAGE 1 OF 1	
1 - 10	± 0.30	REVIEWED	Sun j c	7-5-05	SCALE	5:1	UNIT	mm
OVER 10	± 0.50	APPROVED	Gao hong	7-5-05	PROJECTION			

COMAX ELECTRONICS (HUIZHOU) CO.,LTD.