

①	ITEM NO.	HOUSING COLOUR	SENSITIVITY
	HW-150V(D)	NATURAL	灵敏型
	HW-150V(H)	BLACK	普通型
	HW-150V(L)	WHITE	灵敏型至普通型之间
	HW-150V(M)	RED	迟钝型至普通型之间
	HW-150V(S)	BLACK	迟钝型

P VIEW

规格 Specifications

额定负荷 Rdtngs	DC 12 V 20 mA
初期接触电阻 Initial Contact Resistance	5 Ω Max.
绝缘电阻 Insulation Resistance	DC 500V 60 Sec. 10 MΩ Min.
抗电强度 Dielectric	AC 500 V(50~60Hz) 60 Sec.

① 负荷寿命 Operating Life With Load	10,000 次 Cycles
---------------------------------	-----------------



示意图 SCHEMATIC

安装孔 PIERCING PLAN

5	防尘盖 DUST COVER	PP	1	NATURAL				
4	端子 TERMINAL	C2680R	1	Ag PLATED	A01	增加产品明细栏见 ① 机械寿命变更为负荷寿命见 ①	曹文斌	06-03-29
3	胶身 HOUSING	ABS	1	见上表				
2	弹簧 SPRING	PBSR	1	NATURAL	01		方勇	30-11-04
1	铁壳 FRAME	C2680R	1	Ni PLATED	标号 REV	内容 DESCRIPTION	签名 SIGN.	日期 DATE
序NO.	零件 PART	材料 MATERIAL	数量 QTY	备注 REMARKS	DWG NO. ITEM2435			

TOLERANCES UNLESS OTHERWISE SPEC.		TITLE	SHAKE SWITCH		ITEM NO	HW-150V		
UNDER 1	± 0.10	DRAWN	曹文斌	06-03-29	VERSION	A01	PAGE 1	OF 1
1 - 10	± 0.30	REVIEWED	张念明	06-03-29	SCALE		UNIT	mm
OVER 10	± 0.50	APPROVED	林高全	06-03-29	PROJECTION			

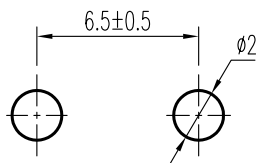
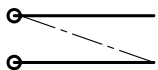
COMAX ELECTRONICS (HUIZHOU) CO.,LTD.