

规格 Specifications

额定负荷 Ratings	DC 30_V 0.3_A
初期接触电阻 Initial Contact Resistance	30_mΩ Max.
绝缘电阻 Insulation Resistance	DC 500_V 60_Sec. 100_MΩ Min.
抗电强度 Dielectric	AC 500_V (50~60HZ) 60_Sec.

操作力 Operating Force (gf)	(v)	
	200 ± 100	450 ± 150
负荷寿命 Operating Life With Load	10,000 次 Cycles	

1P -2T



示意图 SCHEMATIC



安装孔 PIERCING PLAN

6	弹簧 SPRING	STEEL ①	1	NATURAL	A04	C5210R → STEEL 见①	王光云	06-05-30
5	端子 TERMINAL	C2680R	3	Ag PLATED	A03	接触阻抗 → 初期接触电阻 见③	王光云	06-03-28
4	基板 TERMINAL BASE	PHENOL RESIN	1	YELLOW	A02	机械寿命 → 负荷寿命 见⑤	王光云	06-03-18
3	接触片 CONTACT	COPPER WIRE	1	Ag PLATED	A01	ADD: 规格 Specifications 见①	王光荣	06-02-23
2	胶柄 KNOB	P O M	1	G 2 -12	01		赖立辉	28 DEC 01
1	铁壳 FRAME	S P C C	1	Ni PLATED /Sn PLATED BLACKENED	标号 REV	内容 DESCRIPTION	签名 SIGN.	日期 DATE
序NO	零件 PART	材料 MATERIAL	数量 QTY	备注 REMARKS	DWG NO. ITEM0776			

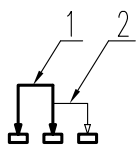
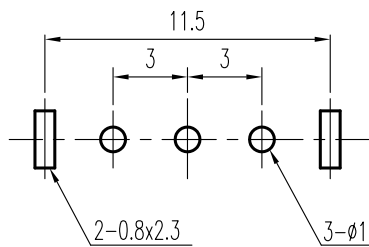
TOLERANCES UNLESS OTHERWISE SPEC.		TITLE	SLIDE SWITCH		ITEM NO	SS-12F48-G		
UNDER 1	± 0.10	DRAWN	王光云	06-05-30	VERSION	A04	PAGE 1	OF 1
1 - 10	± 0.30	REVIEWED	张念明	06-06-01	SCALE		UNIT	mm
OVER 10	± 0.50	APPROVED	高洪	06-06-01	PROJECTION			

COMAX ELECTRONICS (HUIZHOU) CO.,LTD.